

City of Sumner
ENVIRONMENTAL CHECKLIST

Purpose of checklist:

The State Environmental Policy Act (SEPA), chapter 43.21C RCW, requires all governmental agencies to consider the environmental impacts of a proposal before making decisions. An environmental impact statement (EIS) must be prepared for all proposals with probable significant adverse impacts on the quality of the environment. The purpose of this checklist is to provide information to help you and the agency identify impacts from your proposal (and to reduce or avoid impacts from the proposal, if it can be done) and to help the agency decide whether an EIS is required.

Instructions for applicants:

This environmental checklist asks you to describe some basic information about your proposal. Governmental agencies use this checklist to determine whether the environmental impacts of your proposal are significant, requiring preparation of an EIS. Answer the questions briefly, with the most precise information known, or give the best description you can.

You must answer each question accurately and carefully, to the best of your knowledge. In most cases, you should be able to answer the questions from your own observations or project plans without the need to hire experts. If you really do not know the answer, or if a question does not apply to your proposal, write "do not know" or "does not apply." Complete answers to the questions now may avoid unnecessary delays later.

Some questions ask about governmental regulations, such as zoning, shoreline, and landmark designations. Answer these questions if you can. If you have problems, the governmental agencies can assist you.

The checklist questions apply to all parts of your proposal, even if you plan to do them over a period of time or on different parcels of land. Attach any additional information that will help describe your proposal or its environmental effects. The agency to which you submit this checklist may ask you to explain your answers or provide additional information reasonably related to determining if there may be significant adverse impact.

Use of checklist for nonproject proposals:

Complete this checklist for nonproject proposals, even though questions may be answered "does not apply." in addition, complete the supplemental sheet for nonproject actions (part D). For nonproject actions, the references in the checklist to the words "project," "applicant," and "property or site" should be read as "proposal," "proposer," and "affected geographic area," respectively.

A. Background

1. Name of proposed project, if applicable:

Greenwater North

2. Name of applicant:

Greenwater LLC

c/o Investco Financial Corporation

3. Address and phone number of applicant and contact person:

1302 Puyallup Street

Sumner, WA 98390-1604

(253) 863-6200

4. Date checklist prepared:

August 19, 2010

5. Agency requesting checklist:

City of Sumner

6. Proposed timing or schedule (including phasing, if applicable):

The clear and grade activities are anticipated to occur in 2010 - 2011. It is not known when full site development will occur.

7. Do you have any plans for future additions, expansion, or further activity related to or connected with this proposal? If yes, explain.

Yes, the grade and fill activities addressed by this SEPA Checklist will be followed by commercial and industrial development of the site. A conceptual site plan has been included with the application materials that illustrate a potential for 1,328,000 square feet of building footprint for industrial uses, and 30,000 square feet of building footprint for commercial uses. The gross floor area is estimated to be 1,360,000 for industrial uses. A total of -80-94 acres (80-90%) of net usable area area is estimated.

8. List any environmental information you know about that has been prepared, or will be prepared, directly related to this proposal.

- **Wetland Delineation and Fish and Wildlife Habitat Management Plan, prepared by AHBL, July 2009**
- **Traffic Study prepared by TranSystem Corporation for Pierce County for the 8th Street Widening project. An updated Traffic Study will be prepared in conjunction with future site development when specific uses and building sizes are known.**
- **Traffic Study dated December 1999 prepared by SCA Consulting Group for a project at that time known as Greenwater Corporate Park and addendum dated December 2000.**

Note: The three traffic studies submitted herewith rely on previous development proposals for the Greenwater North property. While similar to the current plans, those prior proposals vary somewhat from the currently anticipated ultimate development of this property. Nevertheless, we anticipate that the mitigation recommended in the three prior studies is the appropriate mitigation for the ultimate development of the property with the exception of the left hand turn lanes proposed at the property entrance to 8th Street East. We will submit a supplemental traffic analysis considering this issue at the time we submit building permit applications for the ultimate development of the property.

9. Do you know whether applications are pending for governmental approvals of other proposals directly affecting the property covered by your proposal? If yes, explain.

No.

10. List any government approvals or permits that will be needed for your proposal, if known.

- **SEPA Determination, City of Sumner**
- **Sedimentation and Erosion Control Permit, City of Sumner**
- **Grade & Fill Permit**
- **Flood Development Permit, City of Sumner**
- **RWHA Permit, City of Sumner**
- **NPDES Permit, Department of Ecology**

Future Site Development will require:

- **SEPA Addendum to address traffic impacts and mitigation at time of building permit.**
- **Design Review, City of Sumner**
- **Building Permits, City of Sumner**

11. Give brief, complete description of your proposal, including the proposed uses and the size of the project and site. There are several questions later in this checklist that ask you to describe certain aspects of your proposal. You do not need to repeat those answers on this page. (Lead agencies may modify this form to include additional specific information on project description.)

The project proposes to fill an agricultural site. Due to the amount of fill being proposed as part of the fill and grade permit (collectively the Sedimentation and Erosion Control Permit and the Flood Development Permit), this project will trigger SEPA review. No impacts are proposed to the on-site or off-site wetlands or stream or their buffers.

The SEPA is being completed at this time to include the ultimate development of the property. The future project will include up to 1,330,000 square feet of footprint for industrial development (1,360,00 GFA), 30,000 square feet of commercial development, and 80-94 acres of net usable area, all consistent with the underlying zoning. The specific size and location of the structures housing these uses, however, is not known at this time. In order to facilitate the City's SEPA review for the completed project, we are providing a conceptual site plan consistent with these uses and amount of impervious surface.

A Development Agreement between Sumner and the Applicant has been completed. The Developer Agreement covers this projects as well as properties owned by the Applicant to the south of Stewart Road. . This includes direct discharge of stormwater to the Stuck River, assuming the existing culvert is replaced to provide capacity.

12. Location of the proposal. Give sufficient information for a person to understand the precise location of your proposed project, including a street address, if any, and section, township, and range, if known. If a proposal would occur over a range of area, provide the range or boundaries of the site(s). Provide a legal description, site plan, vicinity map, and topographic map, if reasonably available. While you should submit any plans required by the agency, you are not required to duplicate maps or detailed plans submitted with any permit applications related to this checklist.

Parcel Numbers: 042001-1-000; 042001-1-001; 042001-1-003; 042001-1-027; 042001-1-009; 042001-1-010; 042001-1-014; 042001-1-015; 042001-1-017; 042001-1-018; 042001-1-019

Site Area: 105.1 Acres

Site Address: 14224 Stewart Road, Sumner, WA

A Legal Description is provided on the plan sets.

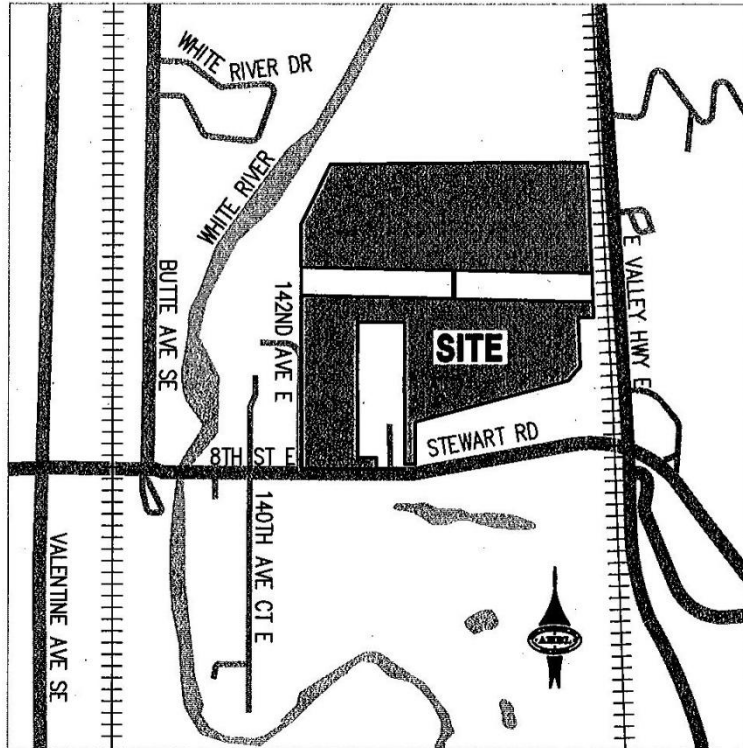

B. ENVIRONMENTAL ELEMENTS

1. Earth

a. General description of the site (circle one): Flat, rolling, hilly, steep slopes, mountainous, other
The site can generally be described as flat with a slight slope to the southwest.

b. What is the steepest slope on the site (approximate percent slope)?
The steepest slope on the site is approximately 5 percent.

c. What general types of soils are found on the site (for example, clay, sand, gravel, peat, muck)? If you know the classification of agricultural soils, specify them and note any prime farmland.

The Soil Survey of Pierce County Area, Washington was reviewed and the following soils were found on the project site: Aquic Xerofluvents (2A), Briscot Loam (6A), Pilchuck fine sand (29A), Puyallup fine sandy loam soil series (31A) and Shalcar muck (38A).

d. Are there surface indications or history of unstable soils in the immediate vicinity? If so, describe.
There is no history of unstable soils in the immediate vicinity.

e. Describe the purpose, type, and approximate quantities of any filling or grading proposed. Indicate source of fill.

200,000 CY to 400,000 CY of fill dirt is estimated to be placed. Actual quantities will depend on final site plan.

The source of fill is unknown at this time.

f. Could erosion occur as a result of clearing, construction, or use? If so, generally describe.

Yes, erosion could occur as a result of clearing and construction. However, the implementation of a temporary sediment and erosion control plan designed by a licensed engineer using Best Management Practices will mitigate impacts.

Sheets C1.5-C1.8 include a temporary sediment and erosion control plan.

g. About what percent of the site will be covered with impervious surfaces after project construction (for example, asphalt or buildings)?

No impervious surface will result from the clear and grade permit. We anticipate that the final development of the property will include 80-90 acres of net usable area. This represents 80-90 percent of the total site area of 105.1 acres.

h. Proposed measures to reduce or control erosion, or other impacts to the earth, if any:

Pursuant to the Development Agreement between the City of Sumner and Greenwater, LLC, the grade and fill and ultimate site development will follow the stormwater management design criteria outlined in the 1992 King County Surface Water Design Manual (KCSWDM).

2. Air

a. What types of emissions to the air would result from the proposal (i.e., dust, automobile, odors, industrial wood smoke) during construction and when the project is completed? If any, generally describe and give approximate quantities if known.

Construction activities at the site will stir up dust particles. Construction vehicles and equipment will also be a potential source of exhaust emissions.

b. Are there any off-site sources of emissions or odor that may affect your proposal? If so, generally describe.

There are no off-site sources of emissions or odor that would affect the project.

c. Proposed measures to reduce or control emissions or other impacts to air, if any:

Watering the ground as needed before and during clearing and grading activities will control dust particles. Vehicles that are not being used in construction activities will be shut off.

3. Water

a. Surface:

1) Is there any surface water body on or in the immediate vicinity of the site (including year-round and seasonal streams, saltwater, lakes, ponds, wetlands)? If yes, describe type and provide names. If appropriate, state what stream or river it flows into.

Yes, there are two wetlands located on the project site that extend off the project site. These wetlands are categorized as Category II and Category IV respectively. There is also an off-site stream located approximately 100 feet from the property. The White (Stuck) River is located approximately 200 feet west from the northwest property corner, and about 860 feet west from the southwest property corner. Per the Wetland Delineation and Fish and Wildlife Habitat Management Plan prepared by AHBL (pages 9 and 10), Wetland A is hydrologically connected via a culvert and during flood events therefore causing Wetland A to be influenced by the White (Stuck) River.

2) Will the project require any work over, in, or adjacent to (within 200 feet) the described waters? If yes, please describe and attach available plans.

No work will occur within 200 feet of the White (Stuck) River. Fill and site development will occur outside of the 125 foot buffer of Wetland A; 35 foot buffer of Wetland B and 100 foot buffer of the off-site stream. Enhancement of Wetland A's buffer will occur (native vegetation plantings).

3) Estimate the amount of fill and dredge material that would be placed in or removed from surface water or wetlands and indicate the area of the site that would be affected. Indicate the source of fill material.

None.

4) Will the proposal require surface water withdrawals or diversions? Give general description, purpose, and approximate quantities if known.

No surface water withdrawals or diversion are anticipated.

5) Does the proposal lie within a 100–year floodplain? If so, note location on the site plan.

Yes, the property is located in the FEMA floodplain on the 1987 FEMA Flood Insurance Rate Maps. The flood elevation is shown on the grade and fill plans. All buildings will be constructed one foot above the base flood elevation.

Per the City's Flood Hazards Area Map Wetland A is located in the 100 year floodplain, however no work will occur within the wetland or its buffer.

6) Does the proposal involve any discharges of waste materials to surface waters? If so, describe the type of waste and anticipated volume of discharge.

No.

b. Ground:

1) Will ground water be withdrawn, or will water be discharged to ground water? Give general description, purpose, and approximate quantities if known.

Groundwater will not be withdrawn and no water will be discharged to the groundwater.

2) Describe waste material that will be discharged into the ground from septic tanks or other sources, if any (for example: Domestic sewage; industrial, containing the following chemicals. . . ; agricultural; etc.). Describe the general size of the system, the number of such systems, the number of houses to be served (if applicable), or the number of animals or humans the system(s) are expected to serve.

None.

c. Water runoff (including stormwater):

1) Describe the source of runoff (including storm water) and method of collection and disposal, if any (include quantities, if known). Where will this water flow? Will this water flow into other waters? If so, describe.

Stormwater runoff from the developed site will be collected and conveyed to proposed stormwater facilities located onsite. Discharge from these facilities will be directed to existing discharge locations that ultimately drain to the Stuck River.

The storm drainage facilities will be designed and constructed in accordance with the terms and regulations of the Developer Agreement between the City of Sumner and Greenwater North LLC.

2) Could waste materials enter ground or surface waters? If so, generally describe.

There is a potential for waste material to enter the surface waters from this development. Pollutants from construction vehicles can enter ground and surface waters if not handled properly. In order to minimize this potential, the design and construction of the surface water management system will comply with the 1992 King County Surface Water Design Manual (KCSWDM) pursuant to the Development Agreement between the City of Sumner and Greenwater, LLC.

d. Proposed measures to reduce or control surface, ground, and runoff water impacts, if any:

All storm drainage treatment features will be designed to meet the requirements of the 1992 King County Surface Water Design Manual (KCSWDM).

4. Plants

a. Check or circle types of vegetation found on the site:

deciduous tree: alder, maple, aspen, other **willow, cottonwoods, red-osier dogwood, salmonberry, spiraea, Indian plum**

evergreen tree: fir, cedar, pine, other ,

shrubs: snowberry, blackberry, elderberry, dewberry, sword fern,

grass

pasture

crop or grain

wet soil plants: cattail, buttercup, bullrush, skunk cabbage, other

water plants: **water lily**, eelgrass, milfoil, other , **pond weed, duck weed**

other types of vegetation

b. What kind and amount of vegetation will be removed or altered?

The project will fill and ultimately develop what are existing agricultural fields. Other than a stream crossing, no disturbance to existing native vegetation is planned to wetlands, or their buffers.

c. List threatened or endangered species known to be on or near the site.

To our knowledge, there are no threatened or endangered plant species known to exist on or near the site.

d. Proposed landscaping, use of native plants, or other measures to preserve or enhance vegetation on the site, if any:

All landscaping will be designed to meet or exceed the requirements of the City of Sumner's Municipal Code. The clear and grade application includes a RWHA permit with a Habitat Management Plan that propose planting native plants in the wetland buffers for enhancement.

5. Animals

a. Circle any birds and animals which have been observed on or near the site or are known to be on or near the site:

birds: hawk, heron, eagle, songbirds, other: crows, black-capped chickadees, marsh wrens, jays
mammals: deer, bear, elk, beaver, other: skunk, opossum, squirrel,
fish: bass, salmon, trout, herring, shellfish, other: steelhead

b. List any threatened or endangered species known to be on or near the site.

No federally listed or State listed threatened, endangered and priority species were identified on the site. WDFW Priority Habitats and Species map and database did not record the presence of priority species on the site.

However, federally listed anadromous and fluvial fish species inhabit the White (Stuck) River located within 200 feet of the northwest corner of the site. The White River, located offsite, contains Bull Trout, Chinook and steelhead, which are within regulated distances of the site. The project would not alter the shoreline of the river and will not change the capacity of the active floodway.

c. Is the site part of a migration route? If so, explain.

The site is located within the Pacific Flyway for migratory birds.

d. Proposed measures to preserve or enhance wildlife, if any:

The ultimate development will have no significant impacts to on-site wildlife. The existing wetland buffers are degraded and will be enhanced to improve wildlife habitat, including blackberry removal and planting of native vegetation.

6. Energy and natural resources

a. What kinds of energy (electric, natural gas, oil, wood stove, solar) will be used to meet the completed project's energy needs? Describe whether it will be used for heating, manufacturing, etc.

Electricity and natural gas will be required to meet the operational needs of the future commercial and industrial uses.

b. Would your project affect the potential use of solar energy by adjacent properties? If so, generally describe.

No.

c. What kinds of energy conservation features are included in the plans of this proposal? List other proposed measures to reduce or control energy impacts, if any:

No special measures are required.

7. Environmental Health

a. Are there any environmental health hazards, including exposure to toxic chemicals, risk of fire and explosion, spill, or hazardous waste, that could occur as a result of this proposal? If so, describe.

Environmental hazards for this proposed project would be related to construction. Any waste that is generated as a result of construction vehicles crossing the stream will be disposed of consistent with city, county, and state regulations. Stormwater will be treated prior to release to the downstream. To our knowledge, the ultimate development of the property with commercial and industrial uses will not generate any environmental health hazards. If that changes with the finalization of the development plans, we will submit supplemental information regarding such hazard concurrent with the building permit applications.

1) Describe special emergency services that might be required.

None.

2) Proposed measures to reduce or control environmental health hazards, if any:

No special measures are proposed.

b. Noise

1) What types of noise exist in the area which may affect your project (for example: traffic, equipment, operation, other)?

The greatest source of noise in the area is generated from rail traffic on the Burlington Northern Railroad tracks abutting the eastern perimeter of the project site.

2) What types and levels of noise would be created by or associated with the project on a short-term or a long-term basis (for example: traffic, construction, operation, other)? Indicate what hours noise would come from the site.

Temporary, short-term noise impacts typical of construction projects will occur with operation of equipment during construction. Construction will normally occur between the hours of 7:00 a.m. and 6:00 p.m.

Long-term noises associated with traffic at the site will occur. However, these noise impacts are consistent with Sumner's plans for the area that designate the site for light industrial and general commercial uses.

3) Proposed measures to reduce or control noise impacts, if any:

Noise impacts associated with construction phase of the project will be limited in duration. To mitigate general noise impacts during the construction phases, measures such as using and regularly maintaining efficient mufflers and quieting devices on all construction equipment and vehicles will be taken. Construction hours will roughly be limited to the normal workday, 7:00 am to 6:00 pm.

8. Land and Shoreline use

a. What is the current use of the site and adjacent properties?

The project site is currently occupied with agricultural fields, with drain tiles, ditches and access roads and it is used as a turf farm. North of the site are agricultural fields, south of the site is Stewart Road, a farm house and barns as well as a Pierce County stream restoration site. East of the property are railroad tracks and west of the property is the Stuck River, 142nd Avenue East and a construction storage yard.

b. Has the site been used for agriculture? If so, describe.

Yes, the property is currently utilized for agricultural use.

c. Describe any structures on the site.

None.

d. Will any structures be demolished? If so, what?

No. There are no structures on site.

e. What is the current zoning classification of the site?

The current zoning for the project site is Light Industrial (M1) and General Commercial (GC).

f. What is the current comprehensive plan designation of the site?

The current Comprehensive Plan designation is Light Industrial (M1) and General Commercial (GC).

g. If applicable, what is the current shoreline master program designation of the site?

A small portion of the northwest portion of the property is located within 200 feet of the shoreline associated with the Stuck River. Wetland A has been determined to be hydrologically connected to the Stuck River. The shoreline designation associated with the river is Urban Conservancy. No development activity will occur within the shoreline jurisdiction.

h. Has any part of the site been classified as an "environmentally sensitive" area? If so, specify.

Yes, there are two wetlands located on the project site that extend off the project site. These wetlands are categorized as Category II and Category IV respectively.

i. Approximately how many people would reside or work in the completed project?

The specific number of people working in the completed project is unknown at this time. This information will be disclosed with subsequent permit applications.

j. Approximately how many people would the completed project displace?

There will not be anyone displaced as a result of the proposed project.

k. Proposed measures to avoid or reduce displacement impacts, if any:

No special measures are proposed.

l. Proposed measures to ensure the proposal is compatible with existing and projected land uses and plans, if any:

The proposed ultimate site development will be compatible with the City's Light Industrial and General Commercial zoning.

9. Housing

a. Approximately how many units would be provided, if any? Indicate whether high, middle, or low-income housing.

None.

b. Approximately how many units, if any, would be eliminated? Indicate whether high, middle, or low-income housing.

None.

c. Proposed measures to reduce or control housing impacts, if any:

No special measures are proposed.

10. Aesthetics

a. What is the tallest height of any proposed structure(s), not including antennas; what is the principal exterior building material(s) proposed?

No structures are proposed with the clear and grade activities. Regarding the ultimate development, the height of the tallest structure will comply with the applicable requirements for buildings in the Light Industrial and General Commercial zones.

b. What views in the immediate vicinity would be altered or obstructed?

No views will be altered or obstructed with clearing and grading. As a result of the ultimate development, views in the vicinity will be impacted. The property is largely surrounded by agricultural uses, therefore impacts to views are not anticipated to be significant.

c. Proposed measures to reduce or control aesthetic impacts, if any:

A landscape planting plan will be prepared for the project consistent with City of Sumner Code requirements.

11. Light and glare

a. What type of light or glare will the proposal produce? What time of day would it mainly occur?

There will be no light and glare associated with the clear and grade proposal. Some exterior building lighting and parking lot lighting will be generated by the ultimate development.

b. Could light or glare from the finished project be a safety hazard or interfere with views?

Lighting will be utilized from dusk until dawn. Lighting will be directed downwards to minimize glare or interference.

c. What existing off-site sources of light or glare may affect your proposal?

None.

d. Proposed measures to reduce or control light and glare impacts, if any:

Parking lot lighting will be directed downward to minimize glare or interference.

12. Recreation

a. What designated and informal recreational opportunities are in the immediate vicinity?

The nearest recreational uses to the project site is Sumner Meadows Golf Links Park located immediately southeast of the project site.

b. Would the proposed project displace any existing recreational uses? If so, describe.

No. The ultimate development would not displace any existing recreational uses.

c. Proposed measures to reduce or control impacts on recreation, including recreation opportunities to be provided by the project or applicant, if any:

The ultimate development will not impact recreational uses.

13. Historic and cultural preservation

a. Are there any places or objects listed on, or proposed for, national, state, or local preservation registers known to be on or next to the site? If so, generally describe.

To our knowledge, no such objects exist near the site.

b. Generally describe any landmarks or evidence of historic, archaeological, scientific, or cultural importance known to be on or next to the site.

To our knowledge, no such objects exist near the site.

c. Proposed measures to reduce or control impacts, if any:

If culturally significant objects are found during site preparation work, the Washington State Office of Archaeology and Historic Preservation will be notified, and appropriate measures will be taken.

14. Transportation

a. Identify public streets and highways serving the site, and describe proposed access to the existing street system. Show on site plans, if any.

The ultimate development will be accessed via Stewart Road which is adjacent to the southern portion of the project site. Highway 167 is located approximately 1 mile west of the site.

b. Is the site currently served by public transit? If not, what is the approximate distance to the nearest transit stop?

No. The closest transit route is Pierce County Bus Route 409, with service to the Sumner industrial area. Pierce County bus route 409 runs up to 138th Avenue East, parallel to SR 167. The closest stop along 138th Avenue East is approximately 1 mile south of the project site.

c. How many parking spaces would the completed project have? How many would the project eliminate?

The specific number of parking spaces for the ultimate development is not known at this time. Final site design will comply with and/or exceed the parking requirements of the City's zoning code.

d. Will the proposal require any new roads or streets, or improvements to existing roads or streets, not including driveways? If so, generally describe (indicate whether public or private).

Stewart Road is currently under construction by others and includes some frontage improvements. The proposed development will include the construction of internal driveways. See the attached traffic studies for a listing of transportation improvements anticipated as part of the ultimate development. As noted above, we do not anticipate that the ultimate development will trigger the need for a left turn at the intersection of the property entrance and 8th Street East. We will submit supplemental traffic analysis regarding this issue concurrent with building permit applications for the ultimate development.

e. Will the project use (or occur in the immediate vicinity of) water, rail, or air transportation? If so, generally describe.

The site is located adjacent to the Burlington Northern Railway. It is not known at this time if a future user would propose a rail span.

f. How many vehicular trips per day would be generated by the completed project? If known, indicate when peak volumes would occur.

Trip generation for the clear and grade activities will be limited to truck trips associated with haul of the fill dirt. The specific trip generation associated with future development is not known at this time. The three previous traffic studies submitted with this SEPA Checklist contemplated the development of the subject property. To the extent the ultimate development of the subject property varies from the assumptions included in those prior studies, we will provide revised information concurrent with building permit applications for the ultimate development .

g. Proposed measures to reduce or control transportation impacts, if any:

The three traffic studies submitted herewith rely on previous development proposals for the Greenwater North property. While similar to the current plans, those prior proposals vary somewhat from the currently anticipated ultimate development of this property. Nevertheless, we anticipate that the mitigation recommended in the three prior studies is the appropriate mitigation for the ultimate development of the property with the exception of the left hand turn at the intersection of the property entrance and 8th Street East. We will submit a supplemental traffic analysis considering this issue at the time we submit building permit applications for the ultimate development of the property.

15. Public services

a. Would the project result in an increased need for public services (for example: fire protection, police protection, health care, schools, other)? If so, generally describe.

Yes, the ultimate development will result in an increased need for services. The need for public services is not anticipated to be beyond the typical demand for an industrial/commercial use.

b. Proposed measures to reduce or control direct impacts on public services, if any.

No special measures are proposed.

16. Utilities

a. Circle utilities currently available at the site: electricity, natural gas, water, refuse service, telephone, sanitary sewer, septic system, other.

Electricity:	Puget Sound Energy
Natural Gas:	Puget Sound Energy
Water:	City of Sumner
Sewer:	City of Sumner
School:	Sumner School District
Telephone:	Qwest

b. Describe the utilities that are proposed for the project, the utility providing the service, and the general construction activities on the site or in the immediate vicinity which might be needed.

All of the above referenced utilities will be required in conjunction with ultimate site development.

C. SIGNATURE

The above answers are true and complete to the best of my knowledge. I understand that the lead agency is relying on them to make its decision.

Signature: Lisa Klein

Name: Lisa Klein

Date Submitted: 8-19-2010